



FINER
H O M E S



STANDARD FEATURES

We Are Serious About Your Satisfaction

- Customer meeting to review your custom plans and specifications
- Customer relations personnel at your service throughout the entire process
- 2 walkthrough inspections and a full home orientation prior to closing
- Full access to our after closing customer care department during the first year
- Finer Homes' Limited Warranty and Residential Warranty Corporation's 10 year Builder's Warranty
- Lifetime invitation to use us as a source of building/construction information and recommendations

Interior Features

- Carrier Energy efficient Heat pump
- 8' ceilings on first floor
- 3 phone jacks; 3 cable outlets
- Prewire for 2 ceiling fan
- 4 flush mount LED lights
- Electric Smooth Top Range
- Microwave, Dishwasher, Disposal, Ice-maker hookup, washer and dryer hookups
- Electric hot water heater
- Brushed nickel light fixtures and door hardware
- Painted interior woodwork
- Cultured marble molded vanity tops
- No wax vinyl floors with many different styles to choose from
- Wide variety of carpet colors from which to choose
- 30" Wall Cabinets
- Stainless steel double bowl kitchen sink with sprayer
- Smoke detectors in all bedrooms
- 6 panel Elite Doors
- Exhaust fans in all baths
- Ventilated shelving in all closets
- Pull down access to attic
- Pedestal sink in 1/2 bath
- Textured or smooth ceiling on 1st floor
- 5 Tub/Shower unit in Master Bath

Exterior Features

- Concrete sidewalk
- Gravel driveway
- Block foundation
- Seed and front yard
- House wrap
- Mailbox
- Windows insulated, single hung, tilt, vinyl, with low "e"
- Thumb latch door knob at front entry door
- Maintenance free vinyl siding
- Aluminum front porch railings
- White vinyl lattice at wood front porches w/ brick piers
- Gutters and downspouts with splash blocks
- Insulated exterior doors
- 2 frost free water spigots and 2 weather proof receptacles
- Landscaping package
- Deadbolts
- PEX plumbing pipes
- Storage trusses
- Dimensional shingles

Great Chesterfield County Schools!

Falling Creek Elementary
Falling Creek Middle
Meadowbrook High

*Just a mile away from
Chippenham Parkway!*

*Plans effective 2/23. All specifications, descriptions and prices are subject to change without notice or obligation. \$5000 CC.

WWW.FINERHOMESINC.NET



FINER
H O M E S

804.748.7575
SALES@FINERHOMESINC.NET



FINER
H O M E S

FALLING
CREEK



Great Chesterfield
County Schools!
Falling Creek Elementary
Falling Creek Middle
Meadowbrook High

Directions: VA-150 S
(Chippenham Parkway)
toward I-95 S
(approx. 5.5 miles).
Take exit toward Route 1
onto Jefferson Davis
Highway. Go approx.
0.9 miles and then turn
left onto Falling Creek Ave.

The Sunflower

Two Story | 1496 sq ft | 3BR 2½BA | \$284,950

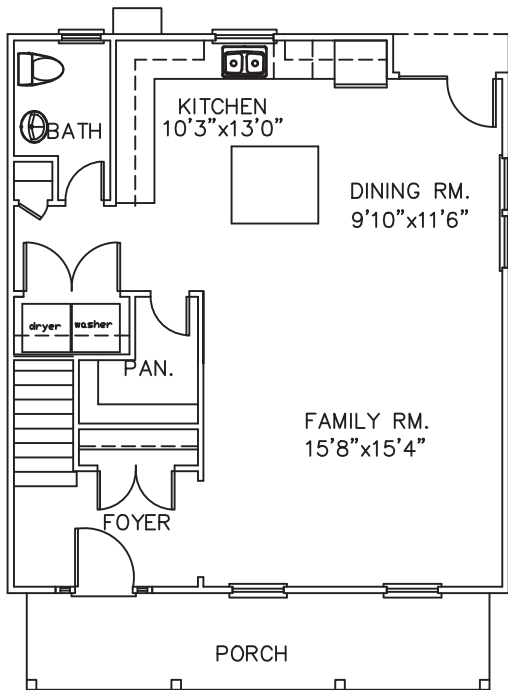

* Home plans may vary or change without notice or obligation. All dimensions are approximate and not all features are shown. Actual building plans may include code updates and design/mechanical changes and improvements.

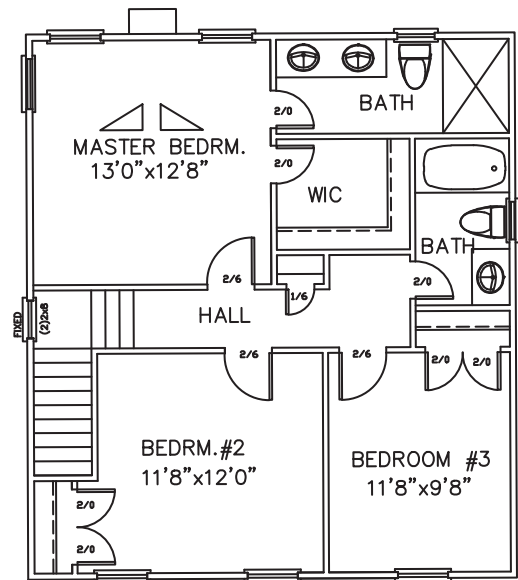

Plans effective 2/2023. All specifications, descriptions and prices are subject to change

